

Lamp Accessories Plastic

Measurements shown in millimeters (mm). To get inches divide mm by 25.4

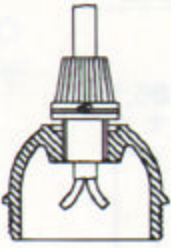

360

Cord Grip (Two parts) with locking washer
For threaded caps M10 x 1 (1/8 IPS)
For round cable H03VV-F (H207, H307)
and SVT 18/2

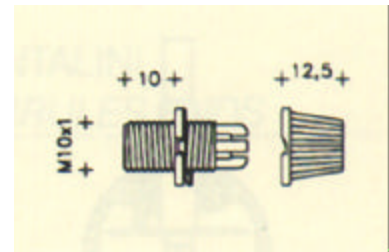

361

Cord Grip (Two parts) with locking washer
M10 x 1 (1/8 IPS) for metal all threads
For round cable H03VV-F (H207, H307)
and SVT 18/2

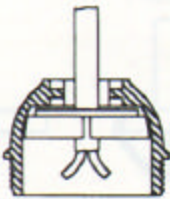
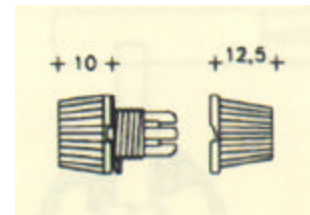

367

Jamming Cord Grip
for Candelabra Base Caps 3000/H19
For flat cable H03VVH2-F (HP07)

362

Jamming Cord Grip
for Medium Base Caps 7000 Series
For flat cable H03VVH2-F (HP07)

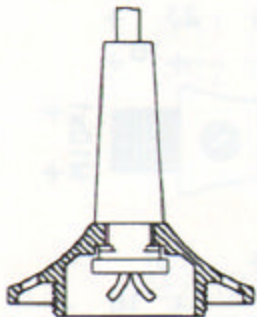
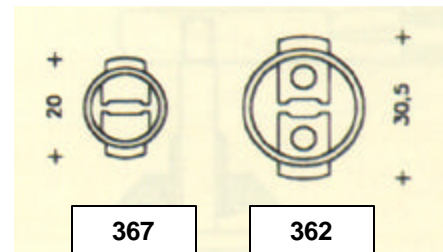

345

Cord Grip with Separator for Caps
For round cable H03VV-F (H207, H307)
and SVT 18/2

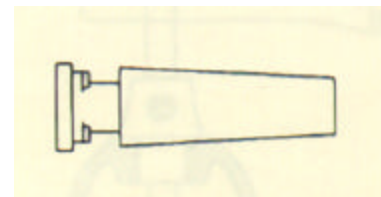

382

Cord Grip for flat cable
H03VVH2-F (HP07)

383

Cord Grip for round cable
H03VV-F (H207, H307)
and SVT 18/2

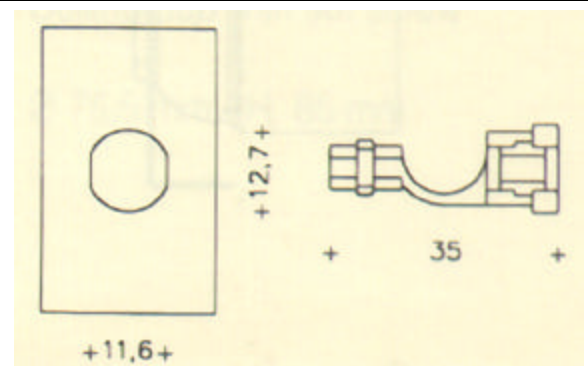

Lamp Accessories

1/8 IPS = Steel Pipe 3/4" OD.
(Slips 7/16" hole)
1/4 IPS = Steel Pipe 1/2" OD.
(Slips 9/16" hole)

Measurements shown in millimeters (mm). To get inches divide mm by 25.4

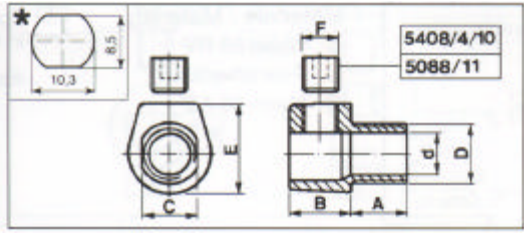

Part Number	Dimensions (mm)						
	A	B	C	D	d	E	F
5100/7/109	9	10	8,5	M10x1	7,2	15	M 7x1
5100/7/114	14	10	8,5	M10x1	7,2	15	M 7x1

5100/7/109
Colors: White, Black, Clear Transparent

5100/7/114
Colors: White, Black

Cord Grip (Cable Clamp) supplied with separate threaded grub.
Suitable for cables:
1) Flat Cable H03VVH2-F min Ø 3x4.8 max Ø 3.6x6
2) Round Cable H03VV-F min Ø 4.8 and max Ø 6.5
M10 Thread (1/8 IPS)
M 10x1: Maximum tightening torque = 130 N cm
Approved for Class II fittings

Application Example for both cord grips 5100/7/109 and 5100/7/114

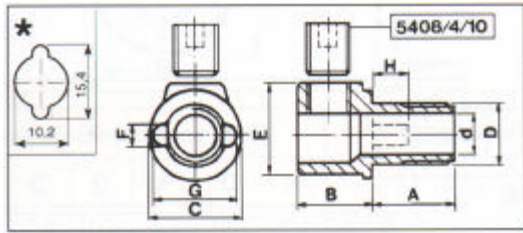
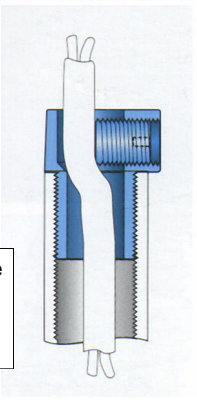

Part Number	Dimensions (mm)								
	A	B	C	D	d	E	F	G	H
5100/6/15	15	10	14,5	M 10x1	6,8	15	3	13,8	6

5100/6/15/C
Cord Grip (Detent Cable Clamp) supplied with separate threaded grub.
Suitable for cables:
Flat Cable H03VVH2-F min Ø 3x4.8 and max Ø 3.9x6.4
Round Cable H03VV-F min Ø 4.8 and max Ø 6.5
M10 Thread (1/8 IPS)
M 10x1: Maximum tightening torque = 130 N cm
Approved for Class II fittings
Color: Clear Transparent

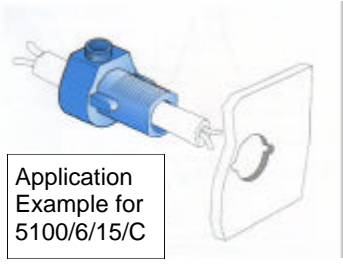

Application Example for 5100/6/15/C

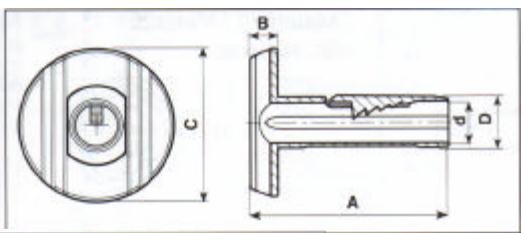

Part Number	Dimensions (mm)				
	A	B	C	D	d
5572	24,5	3,5	19	6,5	5,3

5572 (White color)
Insulating Protections with Cable Clamp for lampholders
Approved for Class II fittings for flat cable H03VVH2-F 2 x 0.75mm²
Material: Nylon 66

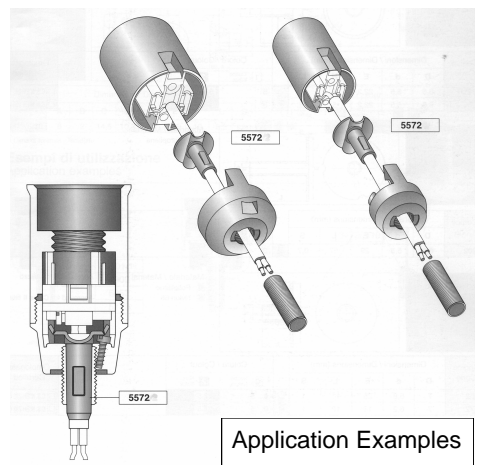

Application Examples