



# Heyco® Straight-Thru Strain Relief Bushings

For Flat Cables, With Flex-Protecting Internal Radii and Extra Body Length

- Sizes for thin .040" (1,0 mm) panel available: SR 4A-6 & SR 3A-4. See charts for details.
- Protects the lifeline of your electric/electronic products by absorbing the forces of pull, push, and twist that may be exerted on the flexible power cord.
- Securely anchors, insulates, and protects cable at panel entry points.
- Standardize panel design! Fill unused SR mounting holes with Heyco Double "D" Plugs, page 3-23.
- See page 3-24, 3-25, and 3-26 for SR hole punches and assembly tools.
- See page 3-12 for Quick Specs.

| WILL FIT THESE CABLES        |                 |                  |         | PANEL DIMENSIONS       |      |                         |      |                         |      | PART NO.    | DESCRIPTION | C BODY LENGTH |      |      |
|------------------------------|-----------------|------------------|---------|------------------------|------|-------------------------|------|-------------------------|------|-------------|-------------|---------------|------|------|
| UL Type Designation          | AWG/ Conductors | Approximate Size |         | A                      |      | B                       |      | Maximum Panel Thickness |      |             |             | Black         | in.  | mm.  |
|                              |                 | in.              | mm.     | Mounting Hole Dia. in. | mm.  | To Prevent Rotation in. | mm.  | in.                     | mm.  |             |             |               |      |      |
| SPT-1                        | 18/3            | .12x.30          | 3,0x7,6 | .500                   | 12,7 | .465                    | 11,8 | .040*                   | 1,0  | <b>1181</b> | SR 4A-6     | .546          | 13,9 |      |
| SPT-2 & HPN                  | 18/2            | .15x.28          | 3,8x7,1 |                        |      |                         |      |                         |      |             |             |               |      |      |
| Same as SR-4A-6 above except |                 |                  |         |                        |      |                         |      |                         | .062 | 1,6         | <b>1187</b> | SR 4N-6       | .546 | 13,9 |
| Same as SR-4A-6 above except |                 |                  |         |                        |      |                         |      |                         | .100 | 2,5         | <b>1190</b> | SR 4K-6       | .546 | 13,9 |

Standard colors black. Consult Heyco for white and other colors.

## For Flat Cables

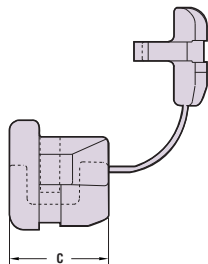
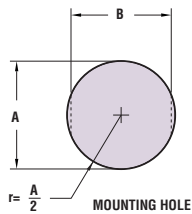

\*To install strain reliefs for .040" (1,0 mm) maximum panel thickness, use Part #0021 (No. R-291) Hand Pliers.

| WILL FIT THESE CABLES         |                 |                  |          | PANEL DIMENSIONS       |       |                         |      |                         |      | PART NO.    | DESCRIPTION | C BODY LENGTH |      |      |
|-------------------------------|-----------------|------------------|----------|------------------------|-------|-------------------------|------|-------------------------|------|-------------|-------------|---------------|------|------|
| UL Type Designation           | AWG/ Conductors | Approximate Size |          | A                      |       | B                       |      | Maximum Panel Thickness |      |             |             | Black         | in.  | mm.  |
|                               |                 | in.              | mm.      | Mounting Hole Dia. in. | mm.   | To Prevent Rotation in. | mm.  | in.                     | mm.  |             |             |               |      |      |
| CLOCK                         | 20/2            | .09x.18          | 2,3x4,6  | .375                   | 9,5   | .345                    | 8,8  | .062                    | 1,6  | <b>1017</b> | SR 2P-4     | .406          | 10,3 |      |
| SPT-1                         | 18/2            | .11x.21          | 2,8x5,3  |                        |       |                         |      |                         |      |             |             |               |      |      |
| Same as SR 2P-4 above except  |                 |                  |          |                        |       |                         |      |                         | .125 | 3,2         | <b>1034</b> | SR 2L-1       | .406 | 10,3 |
| SPT-1                         | 18/2            | .12x.22          | 3,0x5,6  | .437                   | 11,1  | .390                    | 9,9  | .040*                   | 1,0  | <b>1074</b> | SR 3A-4     | .406          | 10,3 |      |
| Same as SR 3A-4 above except  |                 |                  |          |                        |       |                         |      |                         |      |             |             |               |      | .062 |
| Same as SR 3A-4 above except  |                 |                  |          |                        |       |                         |      |                         | .100 | 2,5         | <b>1104</b> | SR 3W-1       |      |      |
| Same as SR 3A-4 above except  |                 |                  |          |                        |       |                         |      |                         | .156 | 4,0         | <b>1094</b> | SR 3L-1       |      |      |
| SPT-1                         | 18/2            | .12x.22          | 3,0x5,6  | .500                   | 12,7  | .445                    | 11,3 | .100                    | 2,5  | <b>1130</b> | SR 4P-4     | .440          | 11,2 |      |
| SPT-1                         | 18/3            | .12x.30          | 3,0x7,6  |                        |       |                         |      |                         |      |             |             |               |      |      |
| HPN                           | 18/2            | .15x.28          | 3,8x7,1  | .500                   | 12,7  | .465                    | 11,8 | .062                    | 1,6  | <b>1120</b> | SR 4N-4     | .406          | 10,3 |      |
| Same as SR 4N-4 above except  |                 |                  |          |                        |       |                         |      |                         |      |             |             |               |      | .100 |
| Same as SR 4N-4 above except  |                 |                  |          |                        |       |                         |      |                         | .156 | 4,0         | <b>1127</b> | SR 4L-4       |      |      |
| SPT-1                         | 18/3            | .12x.30          | 3,0x7,6  | .500                   | 12,7  | .460                    | 11,7 | .095                    | 2,4  | <b>1114</b> | SR 4K-1     | .500          | 12,7 |      |
| SPT-2 & HPN                   | 18/2            | .15x.28          | 3,8x7,1  |                        |       |                         |      |                         |      |             |             |               |      |      |
| HPN                           | 18/3            | .15x.34          | 3,8x8,6  | .500-                  | 12,7- | .515                    | 13,1 |                         |      |             |             |               |      |      |
| SPT-2 & HPN                   | 16/2            | .16x.30          | 4,1x7,6  |                        |       |                         |      |                         |      |             |             |               |      |      |
| Same as SR 4K-1 above except  |                 |                  |          |                        |       |                         |      |                         | .187 | 4,7         | <b>1124</b> | SR 4L-1       | .500 | 12,7 |
| SPT-3                         | 18/2            | .19x.35          | 4,8x8,9  | .562                   | 14,3  | .530                    | 13,5 | .062                    | 13,5 | <b>1170</b> | SR 5KN-4    | .609          | 15,5 |      |
| SPT-2                         | 16/2            | .20x.37          | 5,1x9,4  |                        |       |                         |      |                         |      |             |             |               |      |      |
| SPT-2                         | 18/3            | .15x.40          | 3,8x10,2 | .562                   | 14,3  | .530                    | 13,5 | .062                    | 13,5 | <b>1170</b> | SR 5KN-4    | .609          | 15,5 |      |
| SPT-2                         | 16/3            | .16x.41          | 4,1x10,4 |                        |       |                         |      |                         |      |             |             |               |      |      |
| Same as SR 5KN-4 above except |                 |                  |          |                        |       |                         |      |                         | .125 | 3,2         | <b>1167</b> | SR 5K-4       | .609 | 15,5 |

Standard color black. Consult Heyco for white and other colors.